



- 6 kW
- Double walled construction - grey
- Soapstone cover
- Window aircleaning system
- Automated air flow
- Cast iron grade
- Fireclay firebox
- Flue connection top: 150 mm
- H x W x D: 1124x557x513 mm
- For continuous use
- Fuel: wood, lignite



Automat



Airlogic



FirePlus



TripleAir



Heat storage



Cleaning Air



Double casing



Wood



Continuous use



Brown coal

Certification	1.+2. Stufe 1.BImSchV, CE, 15aB-VG, VKF
Heat output (kW)	6
Min-max heat output (kW)	2,9-6,1
Heat capacity (m3)	116
Flue gas quantity (g/s)	7,4
Air needs Pa	12
Size H x W x D (mm)	1124x557x513
Fuel	wood, lignite
Window size H x W (mm)	300x300
Firebox size W x D x H (mm)	300x280x280
Net weight (kg)	138

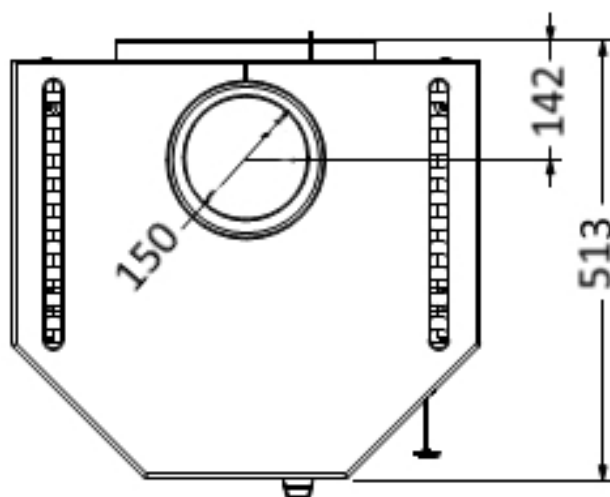
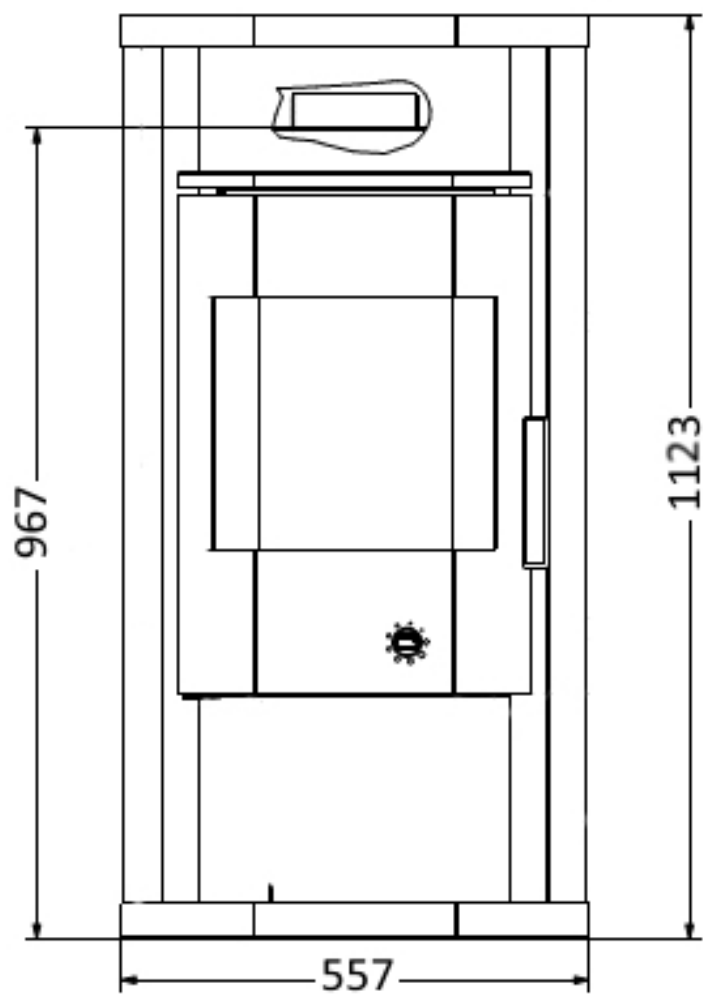

Wamsler SE
3100 Salgótarján, Rákóczi út 53-55
www.wamsler.hu

WAMSLER®
SINCE 1875